

2018

Live Riveted

Dream. Travel. Explore. Live.

Your Airstream adventure awaits...



adventure, inspired by
AIRSTREAM



2018 International range



Missouri

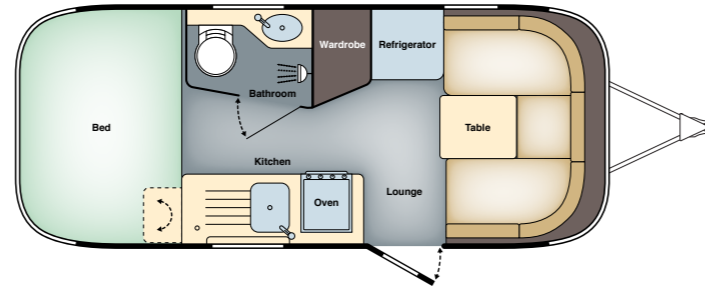

Yukon

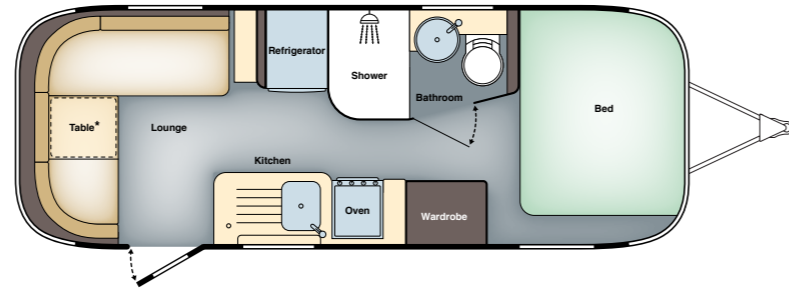

*Table transforms to become the base for the L-shaped seating arrangement.



Colorado

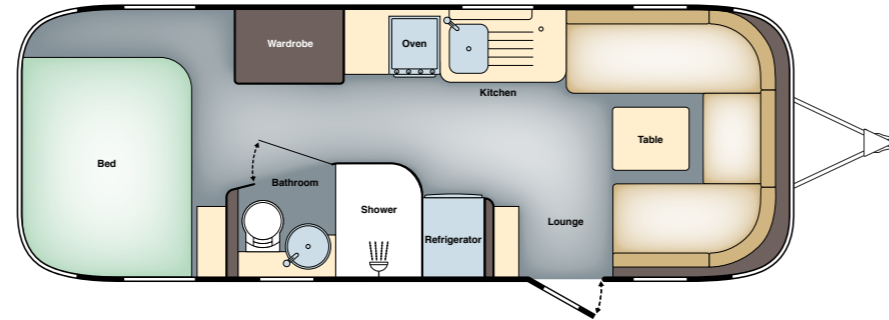



Manhattan Impala



Americana Leather



Manhattan Leather



Specifications	Missouri	Yukon	Colorado
Berths	4	2 / 3	4
Axles	1	2	2
Internal Length	5.32m	6.03m	6.81m
Overall Length*	6.81m	7.60m	8.25m
Overall Width*	2.29m	2.29m	2.50m
Overall Height*	2.65m	2.65m	2.65m
Internal Headroom	1.99m	1.99m	1.99m
Mass in Running Order	1635kg	1870kg	2135kg
Maximum Technical Permissible Laden Mass (MTPLM)	1825kg	2100kg	2400kg

The Mass in Running Order (MRO) comprises:

1. The mass of the empty caravan as supplied by Swift including loose items such as the hook-up cable, kit bag, entrance step, manuals etc
2. 19.8kg allowance for LPG
3. 35kg allowance for water in the fresh water tank.
4. 8.4kg allowance for water in the water heater.

The MRO is calculated with the fresh water tank and boiler full but the toilet flush tank empty. If you travel without water in the fresh water tank the payload can be increased proportionally.

The Maximum Technical Laden Mass (MTPLM) is the maximum mass allowed when the caravan is fully laden.

WARNING: Under no circumstances should the MTPLM be exceeded.

Please note: Any dealer fit options will reduce the overall payload available to the user of the caravan. If you require additional payload it is possible to upgrade the MTPLM to the upper limit. Please contact your Airstream dealer for more information.

The masses are calculated in accordance to EU regulation 1230/2012 and NCC code of practice 304.

*The dimensions and weights given are approximate due to slight variations in suspension ride heights, loading conditions and tyre pressures.

Customers should verify the actual dimensions of their touring caravan before committing to anything that could be impacted by these dimensions

Please note: Any dealer fit options will reduce the overall payload available to the user of the caravan. If you require additional payload it is possible to upgrade the MTPLM to the upper limit. Please contact your Airstream dealer for more information.

Exterior Features

Handcrafted buck riveted aluminium bodyshell, timeless iconic design

Rounded aerodynamic shape for superior towing performance

Fluoropolymer clear coated aluminium panels inside and out

Semi-monocoque all aluminium superstructure

Hand crafted Airstream welded extruded aluminium window frames

Tempered tinted windows with double cam latching system

Custom handcrafted 0.66m wide one-piece entry door with window and cast hinges

Hassle free ZipDee® patio awning

Fixed aluminium 'Thule' entrance step

European specification chassis with overrun brakes and composite insulated floor

Thermal barrier protection between interior and exterior

Temperature reducing one piece white aluminium roof

Use of portal windows to optimise natural light

Stainless steel front stone guard protection

Chrome beltline and rub rail with insert

Polished rear aluminium bumper

Rear registration plate bracket with light

Cast aluminium rear light housings

Stainless steel front and rear grab handles

Aluminium entry door handle

LED entrance door light

Handcrafted aluminium fly screen door

Aluminium LPG gas storage locker

15" Alloy wheels

Spare wheel and tyre including underslung wheel carrier

Exterior access battery box featuring pull out tray with provision for 2 leisure batteries

Exterior under bed access locker with chequer plate lining to floor under bed

Exterior shower with hot and cold water

Exterior gas BBQ connection point



Interior Features

Complete aluminium interior walls and ceiling

Wrap around panoramic front and rear windows

1.99m Internal headroom

Hand crafted Italian Lite-Ply laminated interior cabinetry

Stylish Corian® work surfaces with drain grooves

Choice of 'Americana' or 'Manhattan' leather upholstery schemes

Individually designed seating areas with comfort and functionality in mind

Contemporary rugs to lounge areas

Duvalay Duvalite mattress with lightweight memory fibre technology

Fully adjustable table with telescopic leg for use with bed make up

Heki rooflights utilised in front and rear

Oceanair Railshade blinds to side windows

Seamless vinyl flooring

Low energy LED interior lighting

Overhead roof lockers with LED accent lighting

Directional LED reading/courtesy lights

Under seating storage access from entrance area

Backrest ventilation boards

Hinged washroom door with frosted window

Corian® kitchen worktop with under counter mounted Franke stainless steel sink & Corian® lid

Corian® bathroom worktop with integral Corian® bowl

Safety and Security

Stabilising tow hitch

Smoke alarm

Carbon monoxide detector

CRiS identity number labels on windows and caravan chassis

Keyed deadbolt locking system

Equipment

ALDE central heating and water heating with LCD touchscreen control with daily programming

Dometic 3 Burner cooktop with separate oven and grill

Dometic CK150 extractor above cooker

Sargent EC500 power supply unit with touchscreen control panel

Dometic 110 litre fridge incorporating 12 litre removable freezer compartment (Missouri)

Dometic 190 litre fridge with 35 litre freezer compartment (Yukon & Colorado)

35 litre on-board fresh water tank

Radio/CD/MP3 Player with audio input and Bluetooth capabilities.

Audio speakers set into end roof lockers

Lounge TV station with 230V, 12V and aerial sockets

Bedroom TV station with 12V and aerial socket in bedroom

Status 570 directional aerial

Under locker mounted kitchen roll holder

Size adjustable cutlery tray for optimal use of storage

Centrally heated stainless steel washroom radiator (Yukon & Colorado only)

Brushed steel washroom accessories (model specific)

Eco-Camel orbit shower head

12V washroom ventilation fan

Thetford C260 china bowl cassette toilet with electronic flush

Provision for roof mounted air conditioning unit

Provision for roof mounted solar panel

Provision for roof mounted satellite dish (Yukon & Colorado)

Airstream branded entrance mat

13 Pin 'Jaeger' 12v car connector





airstream-uk.co.uk

Product information, specifications and photography in this brochure were as accurate as possible at the time of printing. Photographs may contain some features that are options on your vehicle. All props are for photographic purposes only and are not included in the specification.

Since we continually strive to improve our products, actual products may differ. Prices and specification are subject to change without notice. All capacities are approximate and dimensions are nominal.

All content and images
© Airstream and Swift Group
Issued July 2017.

adventure, inspired by
 **AIRSTREAM**

Official UK distributor



SWIFT